

Biscuit Processing

Diverter Valves VAR

4



Description ▼

VAR Diverter Valves consist of a cast aluminium body and cover and a rotary inner drum which closes one of the two outlet pipes as required. The rotation of the inner drum is brought about by means of a pneumatic actuator. The inner sealing is ensured by pneumatically inflatable gaskets.

Function ▼

VAR Diverter Valves are suitable for conveying any kind of material, both in powdery and granular form. The pneumatic actuator which activates the inner rotary drum makes it possible to divert the outlet pipe and thereby divert the flow of material from one duct to another.



Application ▼

VAR Diverter Valves are fitted directly on pneumatic conveying ducts whenever it is required to divert the flow of material to different production lines.

Benefits ▼

- ✓ No contamination due to 304 stainless steel contact inserts;
- ✓ Minimum pressure drop thanks to inflatable seal;
- ✓ Minimum friction during diverting operation due to inflatable seal;
- ✓ ATEX-compliant pneumatic actuator and solenoid valves;
- ✓ Use with different materials in one configuration only;
- ✓ Quick process integration thanks to lightweight design and easy handling;
- ✓ Modular design and easy maintenance thanks to reduced number of components.

Biscuit Processing

Diverter Valves VAR



Technical Features / Performance ▼

- ▶ Basic structure manufactured from cast aluminium
- ▶ Operating temperature: -20° C to 80° C (-4° F to 180° F)
- ▶ Diverter operating pressure: max. 3.5 bar (36 PSI)
- ▶ Inflatable seal closure pressure: max. 4 bar (58 PSI)
- ▶ Pneumatic actuator activation pressure: max. 8 bar (116 PSI)
- ▶ Range comprising diameters from 80mm to 150mm (3 to 6 in)
- ▶ Micro-switch box for signalling actuator position
- ▶ Electro-pneumatic actuator with different supply voltages: 24/48/110/230 V AC

Overall Dimensions ▼

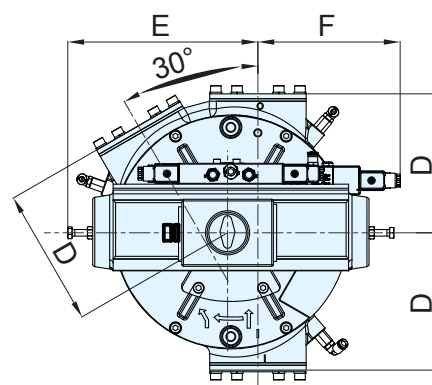
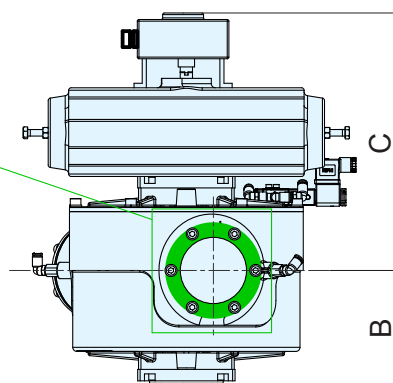
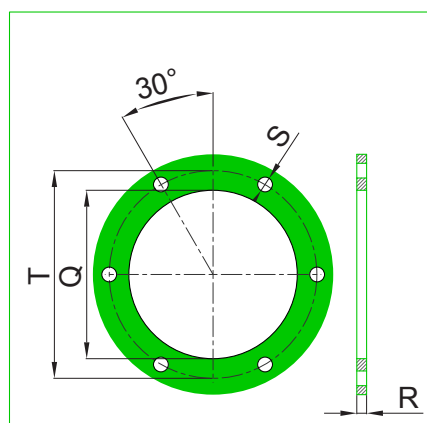

Type	B	C	D	E	F	T	Q	R	S
VAR 080	142	314	169	260	174	103	82	6	9
VAR 100	148	320	209	266	160	127	102		11
VAR 125	181	386	242	299	191	158	127		
VAR 150	197	402	273	305	184	185	158		
VAR 175	216	453	313	432	197	217	177		
VAR 200	233	469	338	436	186	245	208		

Dimensions in mm